

DWG.NO. HW2381215

A

B

C

D

E

F

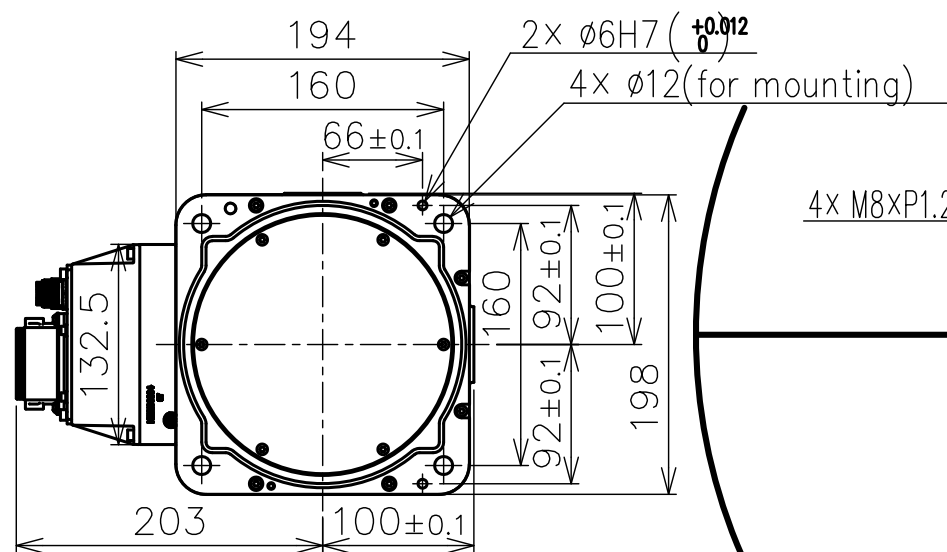

View A (Scale 1:5)

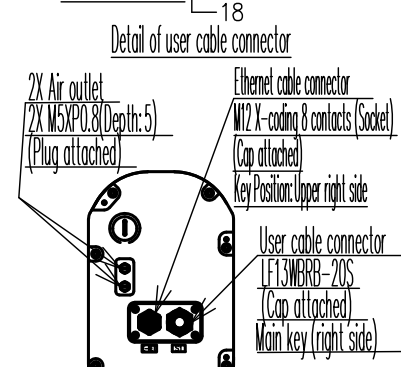
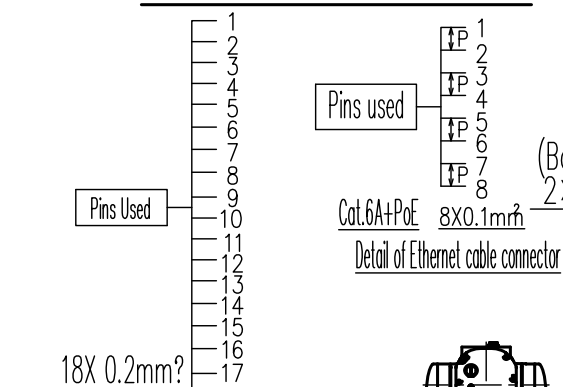

View F (Scale 1:4)

With the user cable from the back

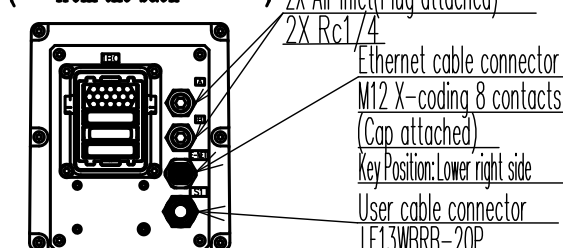

View C (Scale 1:5)

Type	Specification
YR-N1-06VX10-C00	Standard
YR-N1-06VX10-C01	Anti-Corrosive Coat

4x M8xP1.25(Depth:15)

(Both sides)
2x4xM4xP0.7 (Deapth:6)

View B Detail of wrist flange (Scale 1:5)

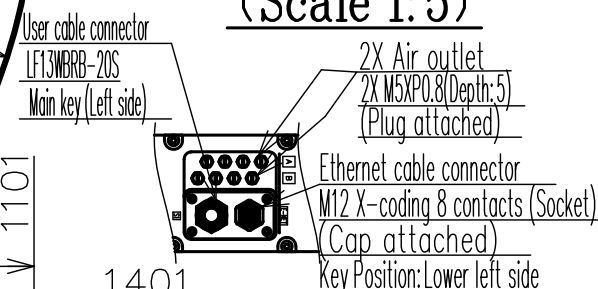

View D (Scale 1:5)

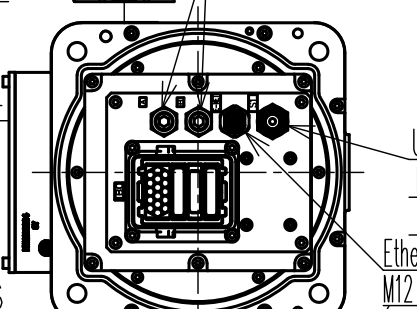
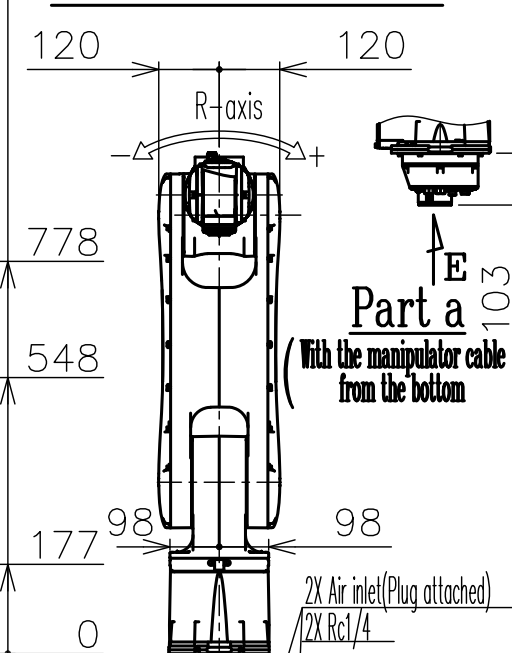

View E (Scale 1:5)

Item	Model	MOTOMAN NEXT-NEX10
Configuration		Vertically articulated
Degree of freedom		6
Payload	Wrist part	10kg
	On U-arm(*1)	1kg
Repeatability(*2)		0.015mm
Range of motion	S-axis	-180°- +180°
	L-axis	-100°- +145°
	U-axis	-70°- +190°
	R-axis	-190°- +190°
	B-axis	-45°- +225°
	T-axis	-360°- +360°
Maximum speed (*3)	S-axis	5.24rad/s,300°/s
	L-axis	4.36rad/s,250°/s
	U-axis	5.93rad/s,340°/s
	R-axis	8.72rad/s,500°/s
	B-axis	8.2rad/s,470°/s
	T-axis	13.96rad/s,800°/s
Allowable moment	R-axis	22Nm (2.24kgfm)
	B-axis	22Nm (2.24kgfm)
	T-axis	11Nm (1.12kgfm)
Allowable inertia (GD ² /4)	R-axis	0.9kg·m ²
	B-axis	0.9kg·m ²
	T-axis	0.3kg·m ²
Mass		58kg
Protection rating		IP67
Clean rating (reference)(*4)		Equivalent to ISO class 5
Mounting method (*5)		Floor-mounted, Wall-mounted, Tilt-mounted, Ceiling-mounted
Ambient conditions	Temperature	0°C - +45°C
	Humidity	20%RH-80%RH(Non-condensing)
	Vibration acceleration	4.9m/s ² (0.5G) or less
	Altitude	1000m or less
	Flatness for installation	0.5mm or less
	Others	Free from explosive and corrosive gas or liquid. Free from excessive electrical noise(plasma). Free from strong magnetic field.
Power requirements(*6)		1KVA
Applicable controller		YNX1000

- *1 Load on the U-arm will vary depending on the load weight of the wrist part.
 *2 Repeatability conforms to ISO 9283.
 *3 The maximum speed in this table is the available maximum value and will vary depending on the load, posture, or range of motion.
 *4 The clean rating is for reference and not guaranteed.
 *5 When the manipulator is installed on a tilt or a wall, the motion of S-axis will be limited.
 *6 The power requirement value is obtained using YASKAWA's in-house measurement conditions and will vary depending on the load, motion pattern, or cycle time.
 *7 The posture in this drawing is in the home position.

User cable connector
LF13WBRB-20P(Cap attached)
Main key (Left side)
Ethernet cable connector
M12 X-coding 8 contacts (Socket)
(Cap attached)
Key Position: Upper right side

Units : mm

Note:
1.All rights reserved.
2.Please note that the data is subject to be deleted without advance notice.
3.No warranty is given in relation to the data including the specification.
4.We are not responsible for any damages or loss caused by the use of the data.

FOR STUDY PURPOSE ONLY

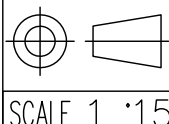

YASKAWA
株式会社 安川電機

Reference Drawing

TITLE MOTOMAN NEXT-NEX10
DIMENSION DIAGRAM

DRWN DATE Jul.4'25
DWG.NO. HW2381215

SIZE A3